

Campus Master Plan





The purpose of the Campus Master Plan is to guide campus developments over the next 20 years in a way which is consistent with the aspirations of UC and the communities it serves, and to ensure the University has the physical infrastructure to support a world-class learning environment.

Details of the site analysis and other information that has informed the draft master plan can be found at www.canterbury.ac.nz/theuni/campus_plan. If you would like to comment please email us at masterplan@canterbury.ac.nz.

Although final decisions will rest with the University of Canterbury Council, we are interested in the views of our stakeholders which will inform development of the master plan document that will be presented to the University Council in February 2011.

Our campus today



The site survey carried out by our consultants identified the following main features of the campus:

- The green, park-like setting is a defining, memorable and valued feature of the campus. However outdoor spaces are generally passive and uninviting.
- The original 1960s concept created an open and functional design, but the addition of new buildings and the incorporation of the adjacent Dovedale site have undermined the sense of coherence.
- There is no recognisable campus heart or main entrance.
- The campus appears dark and inactive after hours, leading to perceptions of poor security and safety.
- While distinctive buildings and landscapes assist users to orient themselves within the campus, there are few well-defined and separate routes for pedestrians, cycles and vehicles.
- The Dovedale and Ilam parts of the campus are poorly connected, and the main student area (UCSA building) is on the edge of the campus and not well-connected with it.

- Most of the university buildings are sound and of good quality, although rather formidable and impenetrable.
- The various activities on the campus tend to be invisible and isolated from each other.

A series of focus groups with students found they wanted a central hub for study and social activities, improved food and retail services, a larger recreation centre, and improved security, transport connections and car parking.

*Far left: NZi3 is a modern facility that is highly visible at the edge of the campus
Above: Spaces around the Science Lecture Theatre are memorable*



Front-back conflict and dominance of vehicles over pedestrians at the centre of the campus



Very weak connection to UCSA and Health Centre



Safe, comfortable and popular outdoor room at the College of Education



Internal space that is a good social hub and interfaces well with campus and learning spaces



Central space at the heart of the campus does not provide amenity at its edges



Popular shortcut between the UCSA and Halls of Residence – poor legibility and poor lighting

Our future needs

UC anticipates a shift in student demographics over the next 20 years as it increases the number of postgraduate students. This will require changes in the type of spaces available on campus

Current spaces within our buildings have proved to be inflexible in their use. Research spaces need upgrading to match new standards and aspirations. New technologies have changed styles of teaching and learning. Student behaviour and expectations have also changed, weakening the distinctions between social and learning spaces. These all require a significant shift in the quality and mix of spaces within our learning environment.

Our consultants carried out extensive discussions within UC regarding our overall vision and plans for teaching and research within each College and recommended spaces specifically designed for the following:

- A positive and inclusive student experience
- A positive University culture and identity
- Empowering 21st century learning
- Supporting and celebrating Māori and Pacific communities
- Improved connections to industry and the community

Recommended developments

A 'base case' scenario has been developed which recommends solutions to the key issues identified by the consultants.

All elements are commended for inclusion in the Plan. Other scenarios present options for the remaining issues, namely potential sites for the College of Education, Recreation Centre, Erksine visitor housing and a cultural centre.

1. The campus heart and main entrance are created by building a 3-storey 'gateway' building connecting the James Hight Library with the Registry and upgrading the lower levels of the Library to create a student hub. The north side of the new building creates a sheltered courtyard while the south side becomes the main entrance to UC. The student hub contains retail and food outlets, the main library, student learning commons, social spaces, flexible learning spaces, meeting rooms, UCSA activities and student services and concentrates all these activities in one area. The 'gateway' building would house externally-focused activities such as visitor reception, liaison, alumni and community relations as well as having exhibition spaces, conference spaces and a performance space.
2. Satellite hubs would be created around some of the branch libraries and would include cafes, student social spaces and flexible learning spaces, with a focus on postgraduate activity.

3. The main entrance would be at the intersection of Ilam Road and University Drive, connecting directly to the gateway building/student hub. Managed visitor parking would be available adjacent to the gateway building.
4. Wayfinding would be improved by creating strong East/West and North/South campus links for pedestrians. Roads would be emphasised (but also limited) by upgrading Arts, Science, Engineering and Forestry Road with drop-off points at the corners. There would be no public vehicle access to the campus heart.
5. Urban design and landscape enhancements would include more bridges over the Avon/Otakaro River and Okeover stream, and the development of stream walks. Routes for pedestrians, cycles and vehicles would be appropriately surfaced and identified.
6. Ilam fields would be redeveloped in conjunction with a new Recreation Centre, and would include an all-weather fitness track and a new lane for better connection with the Dovedale site.

Also recommended are a general shift to a higher proportion of spaces for innovative learning (such as group and project work) and a smaller proportion of large, tiered lecture theatres and the opening up of ground floors of buildings as opportunities arise (especially those adjacent to the campus heart and the East/West and North/South links).

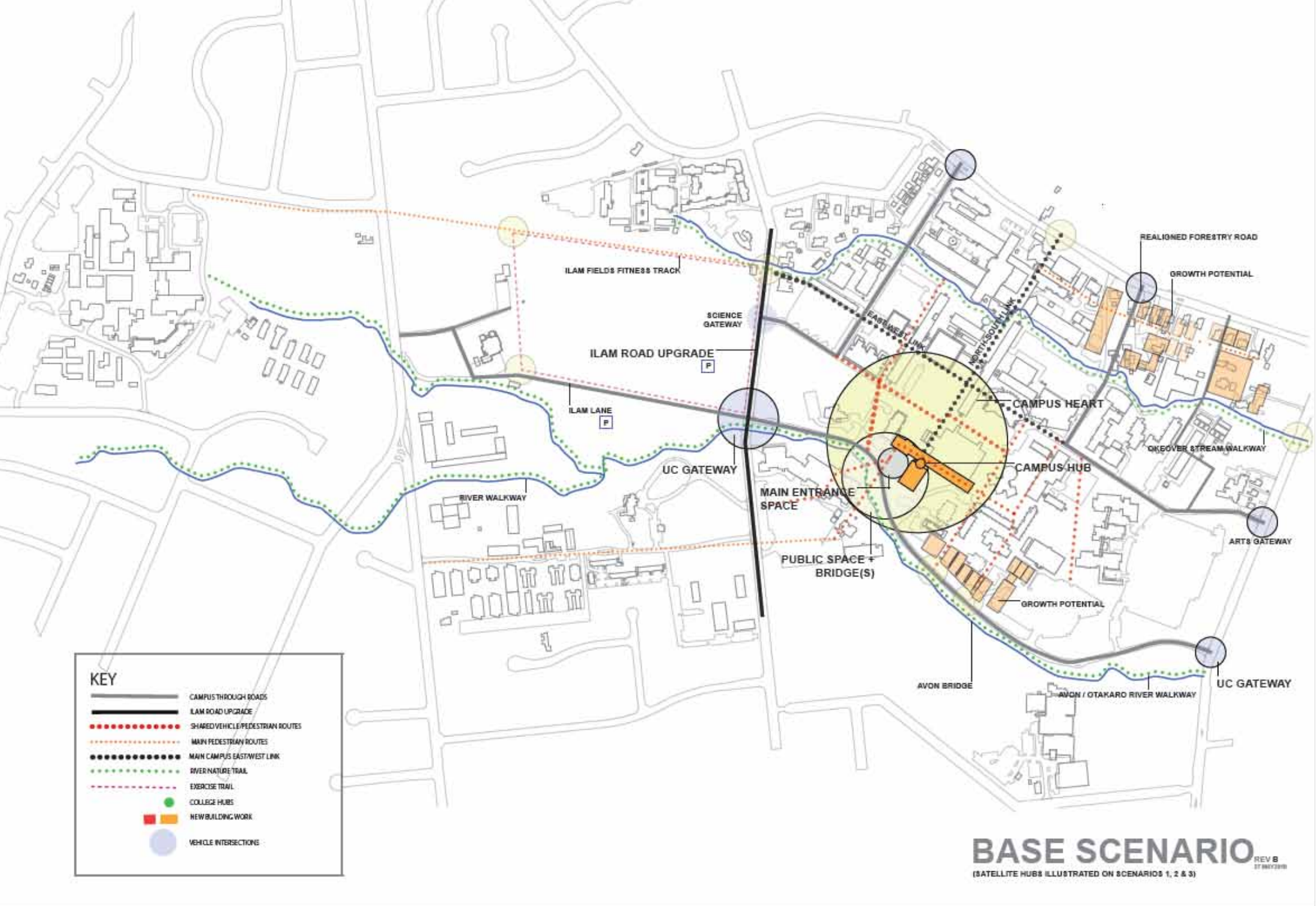



Artist's impression of the gateway/link building on University Drive



Illustration by www.stantialletstudio.co.nz

Artist's impression of the gateway/link building and student hub development in the James Hight Library

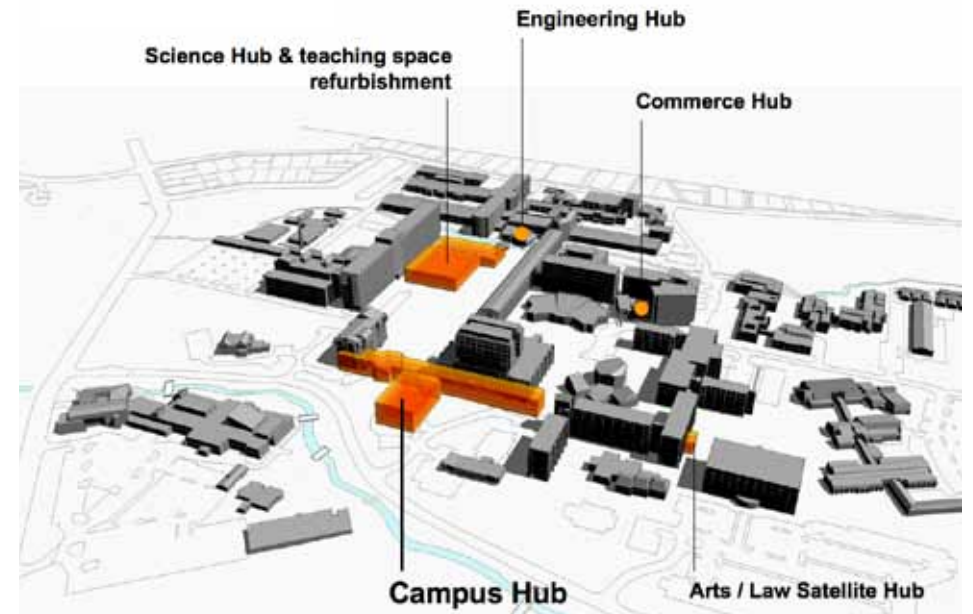
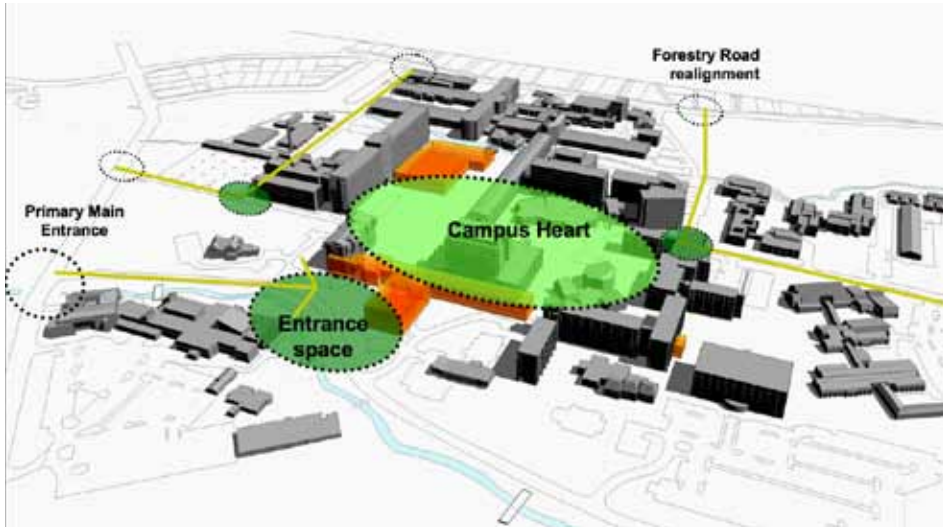

Examples of innovative campus developments



Campus Hub

Graphic Technology Building, Royal Melbourne Institute of Technology (Brunswick) by John Wardle Architects; Olympic Sculpture Park, Seattle by Weiss/Manfredi

visible activity | light | engaging imagery | welcome | comfort | choice

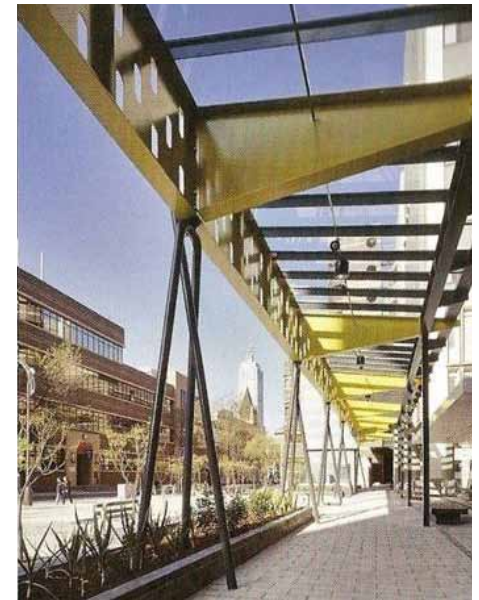

Cross-campus Links

Royal Melbourne Institute of Technology (Bowen Street Loggia) by Peter Elliot; Melbourne Exhibition Centre

Visual and physical connection | shelter and comfort | visual interest | vibrancy | places to sit, meet and study | active edges | choice | safety

Key elements – scenario 1

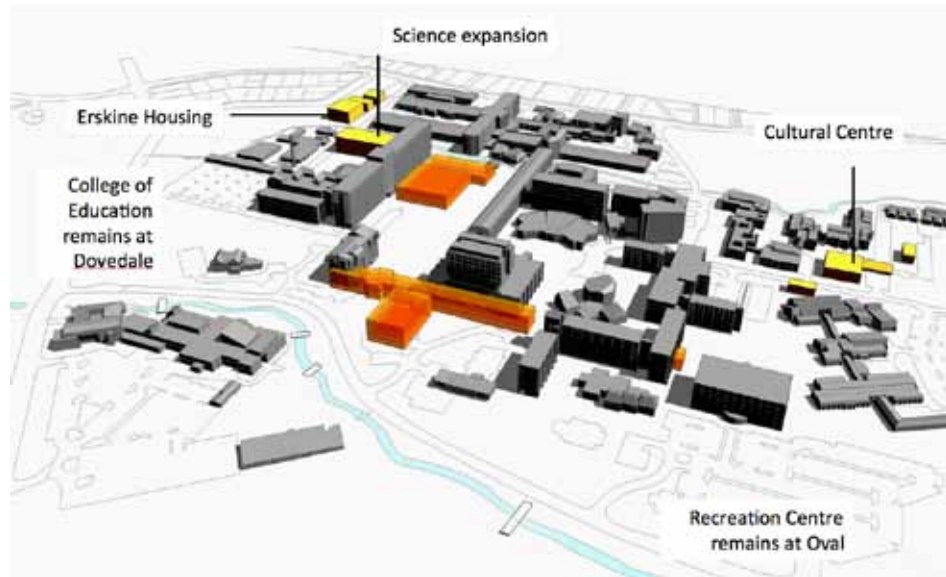

This scenario has the least physical and structural changes to the campus. Its focus is on enhancing the existing situation, incorporating additional buildings and providing for future growth and change.

1. College of Education remains at Dovedale Avenue
2. UCSA and its clubs remain in the existing UCSA building
3. UC Registry and its administration functions remain in Registry/PSL
4. A campus hub is created (base scenario)
5. Potential Arts expansion along University Drive

6. Potential Science expansion on site north of old Physical Sciences Library
7. Potential Engineering expansion on Creyke Road, with realignment of Forestry Road
8. Addition to Forestry building on corner to create a more active area
9. Erskine housing on Montana Avenue
10. Recreation Centre upgraded and remaining in current location
11. Carparking largely status quo

Key elements – scenario 2

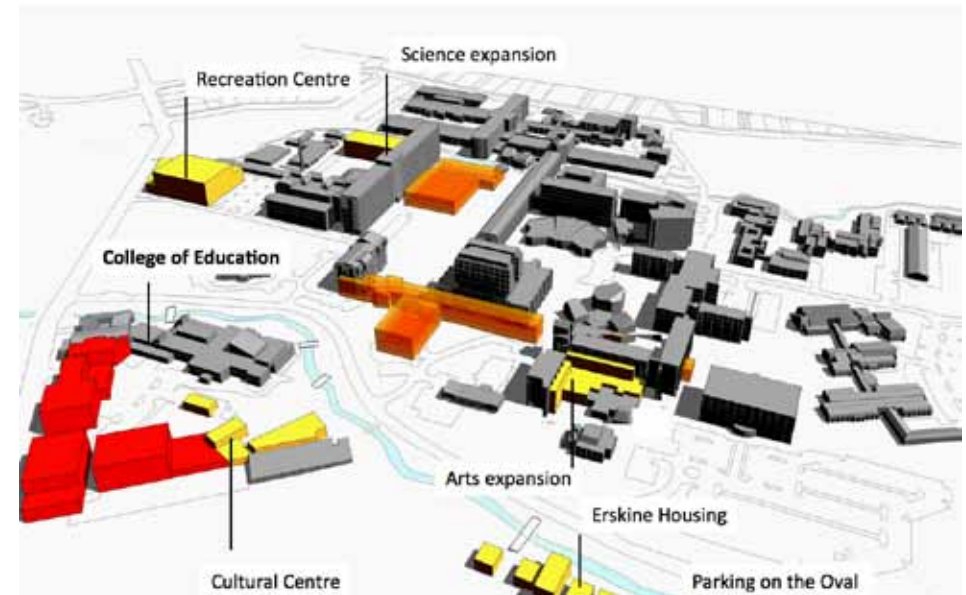

This anticipated future campus integrates the student experience with a more centralised campus and major new building projects. This creates a viable heart to the campus with increased 24/7 vitality and activity around the campus hub. Synergies between the College of Education and/or Aotahi and a cultural centre on the existing UCSA site are possible.

1. College of Education moved to the UCSA carpark
2. Recreation Centre located on Science Road/ Ilam Road corner site
3. UCSA activities included in the Recreation Centre, Campus and Science hubs

4. Retail activities moved into the campus hub
5. Cultural centre located across Avon/Otakaro River behind Ngaio Marsh Theatre
6. Science expansion located on site north of old Physical Sciences Library
7. Potential expansion for Engineering along Creyke Road
8. Alumni Centre in Okeover
9. Addition to Forestry building on corner to create a more active area
10. Erskine housing located on the Oval

Key elements – scenario 3

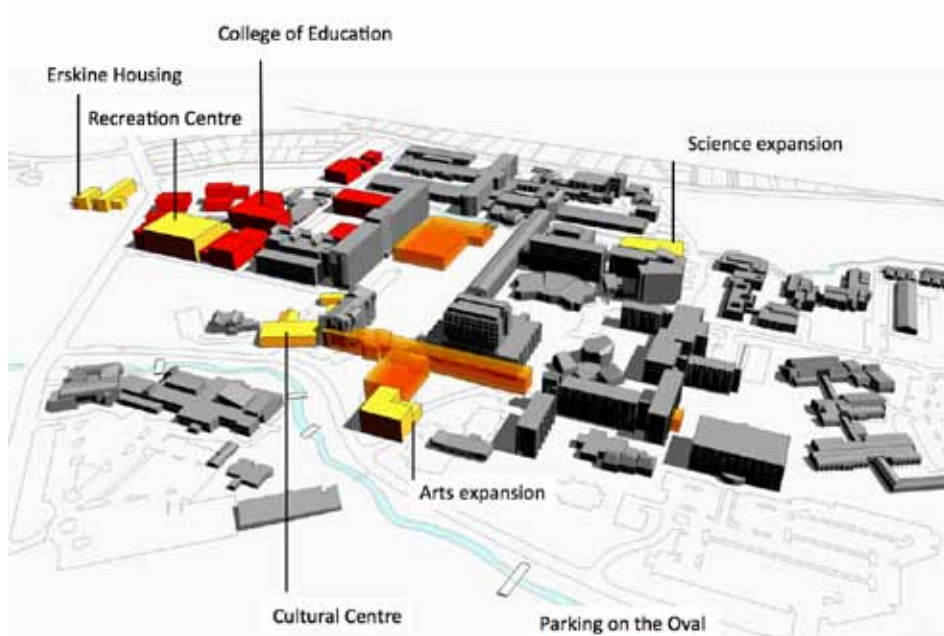

This scenario encompasses some of the outcomes of scenario 2 and also provides for academic and social synergies between the College of Education / College of Science and the Recreation Centre. A main entrance complex of buildings including public interface functions is provided at the main entrance space.

1. College of Education located on Science Road /Okeover Stream site
2. Recreation Centre located on Science Road/ Ilam Road corner site
3. UCSA activities included in the Recreation Centre, Campus and Science hubs
4. Retail activities moved into the campus hub
5. Cultural Centre located on front entry lawn; Okeover House moved and gallery space located adjacent to complex to form an entrance building cluster
6. Potential Arts expansion in Fine Arts buildings and additions to existing buildings and Arts lecture theatres
7. Potential Science expansion located next to Commerce and on Montana Avenue
8. Potential expansion for Engineering along Creyke Road
9. Addition to Forestry building on corner to create a more active area
10. Erskine housing located by University Hall (replacing the current ware/Maori student study centre)

University of Canterbury

Te Whare Wānanga o Waitaha
Private Bag 4800
Christchurch 8140
New Zealand

Telephone: +64 3 366 7001

Facsimile: +64 3 364 2999

www.canterbury.ac.nz